

200W FOLDABLE SOLAR PANEL

MODEL NO: DA200W-BC

OPERATING & MAINTENANCE INSTRUCTIONS

INTRODUCTION







Thank you for purchasing this Foldable Solar Panel. Before attempting to use this product, please read this manual thoroughly and follow the instructions carefully. In doing so you will ensure the safety of yourself and that of others around you, and you can look forward to your purchase giving you long and satisfactory service. Please keep these instructions in a safe place for future reference.

ENVIRONMENTAL RECYCLING POLICY

Through purchase of this product, the customer is taking on the obligation to deal with the WEEE in accordance with the WEEE regulations in relation to the treatment, recycling & recovery and environmentally sound disposal of the WEEE.

In effect, this means that this product must not be disposed of with general household waste but in accordance with the laws governing Waste Electrical and Electronic Equipment (WEEE) at a recognised disposal facility.

SAFETY SYMBOLS SHOWN ON THE PRODUCT

	Read this instruction manual and the manual for the device being charged before use		DO NOT incinerate
	Warning: Battery Charging		Harmful to aquatic life
	Warning: Risk of electrical shock if not used correctly		Protect from rain/ water
	Keep out of reach of children		

GENERAL HAZARDS & SAFETY

- Keep your solar panel, junction box & cables away from any liquids at all times.
- Keep the solar panel and junction box clean at all times (**ALWAYS** check connectors to ensure they're free of grit before plugging them in).
- This appliance is **NOT** intended to be used by people (including children) with reduced physical or mental capabilities, or those who are under the influence of drugs or alcohol.
- **DO NOT** use the solar panel to charge non-rechargeable batteries. Doing so may result in harm to the user and/or damage the solar panel and controller. Only use the provided solar panel, regulator and adaptors/wiring provided in the kit.
- Explosive gases. The battery/power bank should be mounted in a well-ventilated area, as far as possible from any ignition sources.
- **DO NOT** smoke or have a naked flame in the vicinity of the battery/power bank under charge.
- **NEVER** tamper with or pull any component of the solar panel, junction box or wiring apart. If you do so, you will void the warranty.
- **DO NOT** flex or bend the solar panels.
- **DO NOT** step on or place objects on top of the solar panels.
- **ALWAYS** store the solar panel folded, protected from the weather and with good ventilation.
- Ensure nothing sharp or heavy could potentially damage the solar panel during transport or storage.
- It is recommended to charge the storage battery/power bank that has an input of 12V.
- **DO NOT** charge a battery/power bank without a built-in voltage regulator.
- **DO NOT** place solar panel on your vehicle's bonnet or paintwork during use.

OVERVIEW LIST

NO	DESCRIPTION	NO	DESCRIPTION
	Solar Panel (x4)	8	Storage Pocket
2	Carrying Handles (x2)		
3	Magnetic Catches (x2)		
4	Support Arms (x4)		
5	Buckle Straps (x2)		
6	Junction Box		
7	Hardwired MC4 Connection Cable		



CHARGING THE BATTERY/POWER BANK

The battery power of a power station will be consumed during use. You can charge the power station as follows:

CHARGING BATTERY/POWER STATION

1. Connect the battery/power stations 4 way MC4 charging cable to the solar panels hardwired MC4 cable connection.
2. Open the solar panel so the active cells are facing towards the sun, using the support arms if needed.
3. Insert the appropriate DC plug (DC7909 shown) into the charging port of the battery/power station.
4. The battery/power station should automatically start charging.

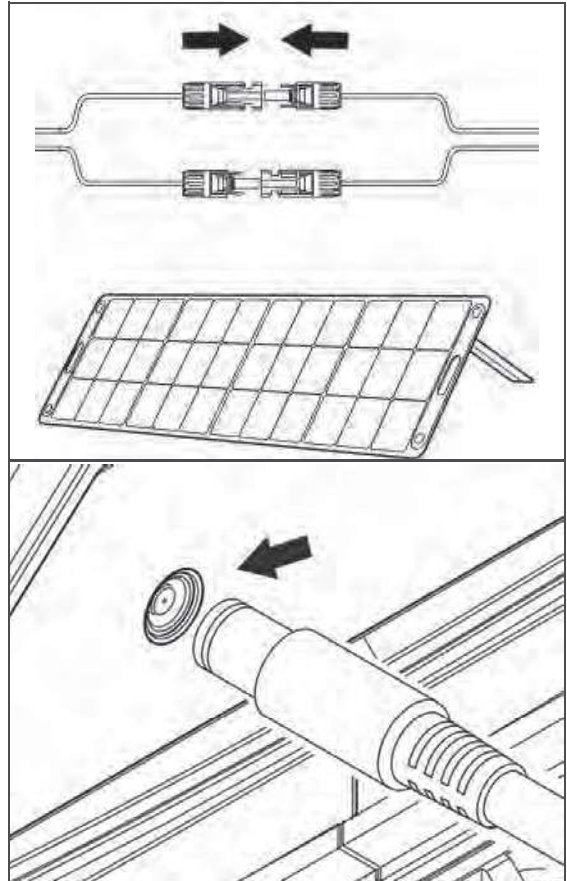

STORAGE & MAINTENANCE

1. Store the solar panel at an ambient temperature of 10°C to 30°C, away from water, heat and other metal objects.
 2. For safety reasons, **DO NOT** store the product in an ambient temperature above 45°C or below -10°C for extended periods of time.
 3. To clean, wipe surfaces with a clean damp cloth and wipe dry. **DO NOT** use any chemical or abrasive cleaning solutions or products.
-



SPECIFICATIONS

Item	Specification
Model	DA200W-BC
Part Number	DA20250101
Weight	7.2kg
Size (D x W x H)	Open: 1910mm x 695mm x 6mm
	Folded: 6960mm x525mm 25mm
Solar Cell Type	Monocrystalline,HPBC
Solar Panel Quantity	4
Solar Cell Orientation (Optimal Tilt Angle)	Winter: Location Latitude + 15° Summer: Location Latitude - 15°
Application Class	Class A
Maximum Power	200W
Power Tolerance	+5%
Optimum Operating Voltage	18V
Optimum Operating Current	11.11A
Open Circuit Voltage	21.6V
Short Circuit Voltage	11.78A
Cell Efficiency	25.8%
Maximum System Voltage	1000 VDC (IEC/600 VDC) (UL)
Maximum Series Fuse Rating	10A
Operating Temperature Range	-40°C - 85°C / -40°F - 185°F
Nominal Operating Cell Temperature	45°C (±2°C)
Temperature Coefficient of Pmax	-0.38%/°C
Insulation Protection Class	Class III
Ingress Protection Rating (IP)	IP20

DIAGRAM

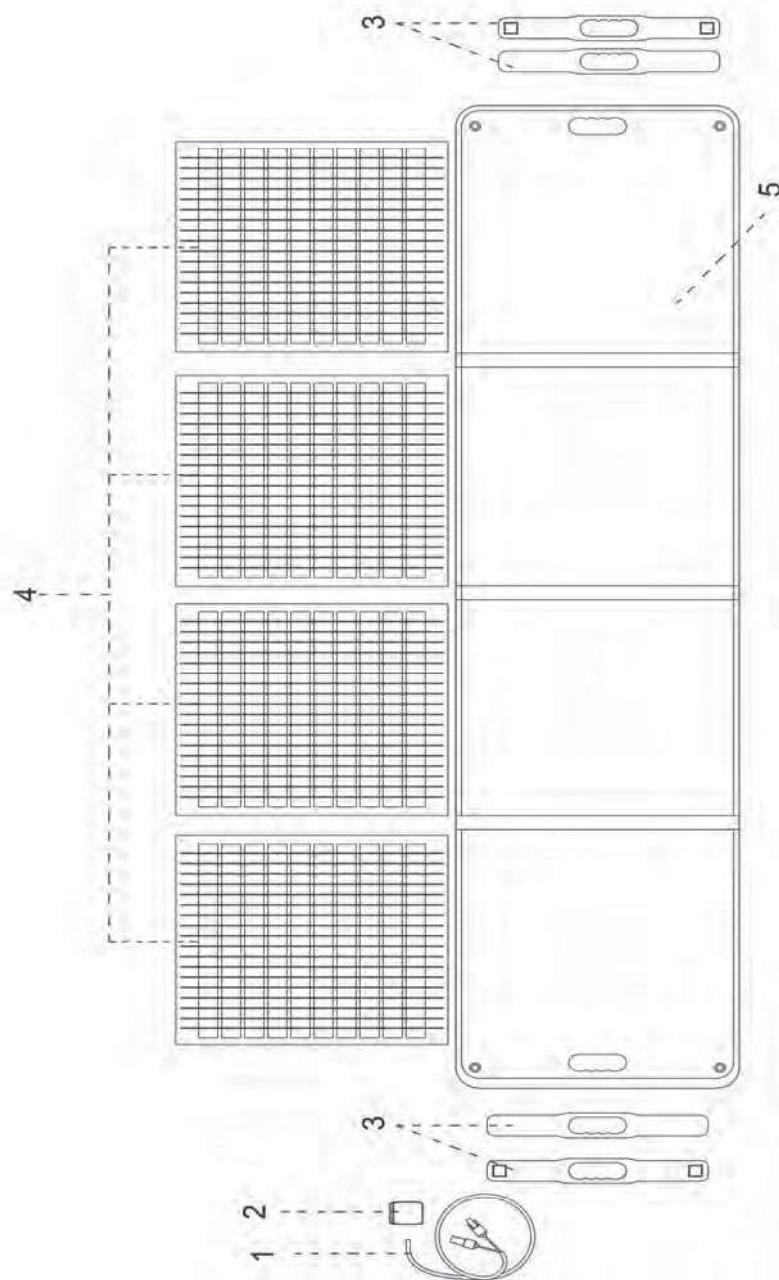

NO	DESCRIPTION	NO	DESCRIPTION
1	Hardwired Connection Cable (with MC4 Connectors)	4	(ETFE) Solar Panels (x4)
2	Junction Box	5	Sewn Cloth Cover with Storage Pocket and Support Arms
3	Plastic Handles with Magnetic Catches		